

分筆予定図 S=1:250

嘉穂郡桂川町大字土居 地内

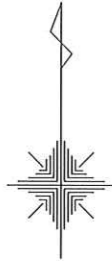

作成者 福岡県田川市中央町4番20号
 あおい合同土地家屋調査士事務所
 土地家屋調査士 鬼塚 雅直
 令和 5年12月11日作成



地番	面積
⑨410-9	256.0221685 m ²
⑩410-10	26.0310340 m ²
⑪410-11	26.1022510 m ²
①457-1	124.2230990 m ²
②456-3	0.5932350 m ²

	地番	面積
1号地	①456-1	170.7458730 m ²
	②457-3	95.5393960 m ²
2号地	①410-1	200.0146630 m ²
3号地	②410-2	200.0154855 m ²
4号地	③410-3	266.5790345 m ²
5号地	④410-4	213.3941145 m ²
6号地	⑤410-5	238.6016710 m ²
7号地	⑥410-6	200.2700380 m ²
8号地	⑦410-7	238.8866605 m ²
9号地	⑧410-8	221.9401380 m ²

合筆後地番: 456-1
 合筆後面積: 266.28m²

座標一覧表

測点名	X座標	Y座標
HB222	64440.308	-29930.091
HB221	64437.095	-29929.734
HB220	64433.846	-29929.681
HA123	64433.944	-29921.058
HA125	64434.018	-29908.660
HA121	64443.206	-29910.617
HA122	64442.638	-29918.862
BP29	64441.154	-29930.185
BP26	64448.075	-29911.640
BP27	64446.979	-29927.805
BP28	64443.784	-29930.476
AK1	64468.605	-29915.064
AK2	64467.353	-29914.732
AK3	64465.075	-29914.155
AK4	64456.504	-29912.366
AK5	64454.198	-29911.909
BP1	64454.072	-29911.869
BP2	64456.841	-29898.676
BP3	64471.480	-29901.943
AK12	64472.889	-29895.511
BP6	64458.648	-29890.083
BP5	64459.548	-29885.769
BP4	64474.349	-29888.874
AK13	64476.740	-29877.997
BP7	64450.847	-29888.328
BP8	64453.197	-29886.818
BP9	64456.021	-29873.397
BP10	64442.646	-29870.427
BP13	64441.072	-29886.134
BP12	64439.562	-29883.758
BP11	64440.017	-29881.792
BP15	64434.120	-29880.476
BP16	64420.130	-29877.353
AK16	64422.669	-29865.618
AK15	64422.986	-29865.956
AK14	64424.698	-29866.442
AK11	64418.800	-29883.502
BP14	64433.252	-29884.378
BP30	64431.940	-29890.254
BP18	64431.062	-29894.156
BP17	64417.137	-29891.023
AK9	64422.959	-29904.507
AK10	64414.657	-29902.232
BP19	64436.922	-29895.474
BP25	64434.278	-29907.083
AK7	64447.910	-29910.180
AK8	64434.697	-29907.179
BP20	64437.370	-29893.505
BP21	64439.756	-29892.007
BP22	64449.484	-29894.189
BP23	64451.103	-29896.712
BP24	64448.243	-29910.270
AK6	64453.339	-29911.636
HA119	64453.992	-29912.884
HB267	64452.735	-29931.822
HB224	64441.062	-29930.883
HB223	64440.230	-29930.788

Y=-29.000

Y=-29.950

Y=-29.900

Y=-29.850

X=64.500

現況平面図

X=64.500

S=1:250 (A1)

座標リスト

点名	X座標	Y座標	標高
Z-1	64442.884	-29931.589	
Z-2	64554.325	-29944.741	10.00
T1	64447.794	-29910.624	
T2	64414.839	-29889.211	9.75

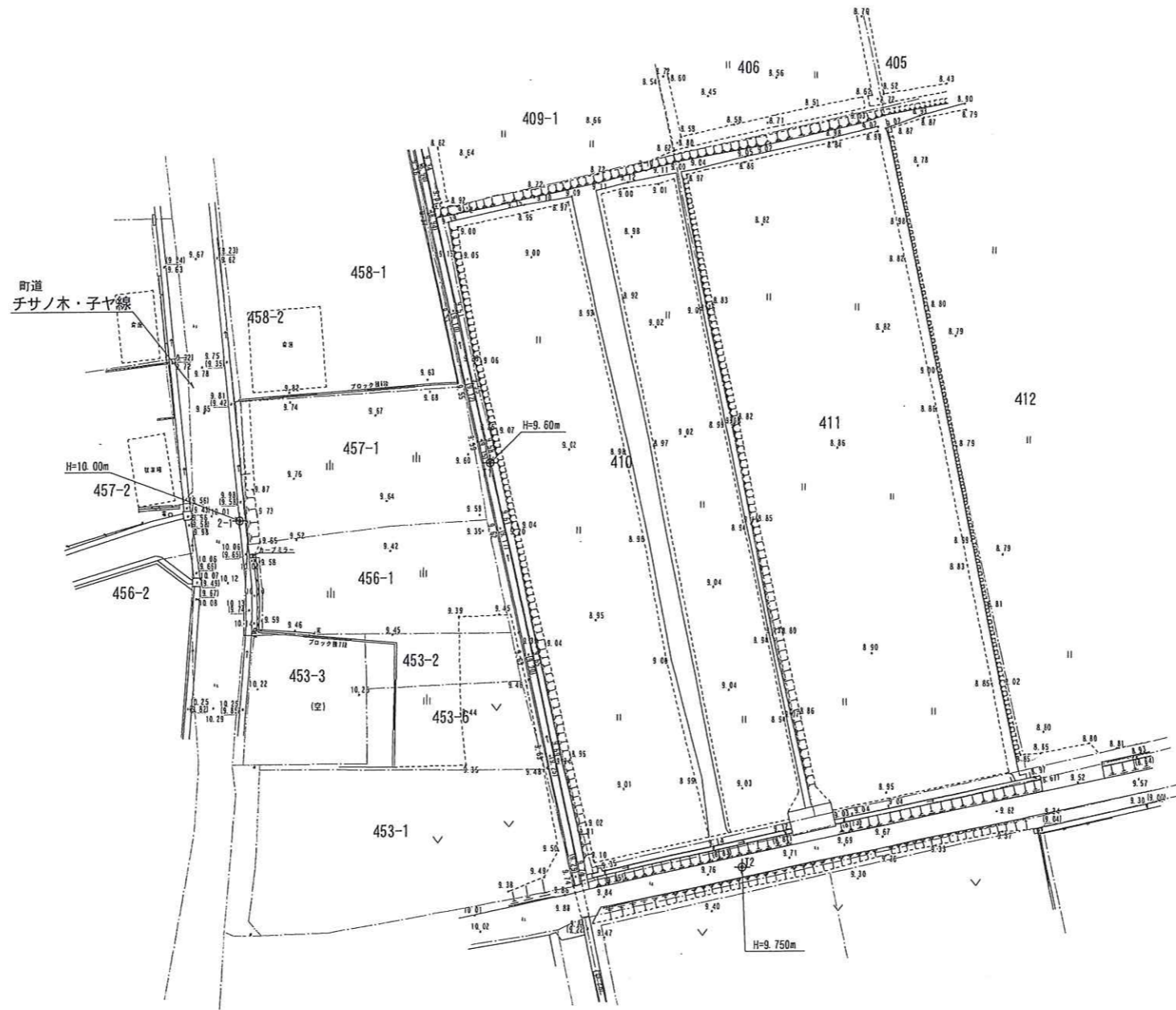

X=64.450

X=64.450

X=64.400

X=64.400

Y=-29.950

Y=-29.900

Y=-29.850

所在地	嘉穂郡桂川町大字土居410番外3筆	作成者	田川郡川崎町大字川崎960 南中村測量設計事務所 測量士 中村己年人	縮尺	S=1:250 (A1) S=1:500 (A3)	現況平面図
作成年月日	令和5年6月6日					

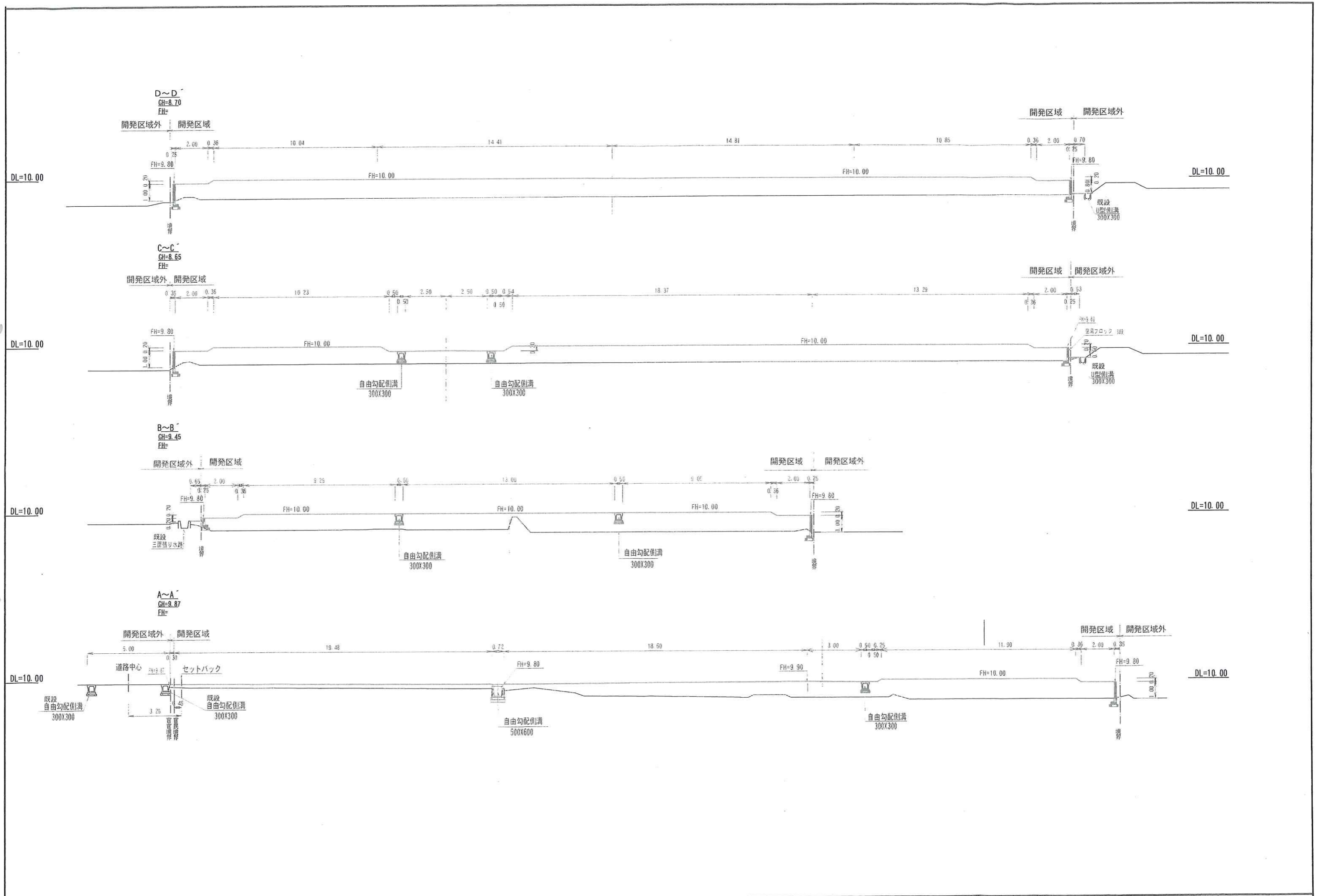

所在地	嘉穂郡桂川町大字土居410番外3外筆	作成者	田川郡川崎町大字川崎960 中村測量設計事務所 測量士 中村己年人	縮尺	S=1:100	断面図
				作成年月日	令和5年6月6日	

X=64.500

Table with columns: 地番, Xn, Yn, Yn-1, Xn-1, Xn-2, Yn-2. Rows include plots like 地番 G-1 and their respective coordinates.

Table with columns: 地番, Xn, Yn, Yn-1, Xn-1, Xn-2, Yn-2. Rows include plots like 地番 G-2 and their respective coordinates.

Table with columns: 地番, Xn, Yn, Yn-1, Xn-1, Xn-2, Yn-2. Rows include plots like 地番 G-3 and their respective coordinates.

Table with columns: 地番, Xn, Yn, Yn-1, Xn-1, Xn-2, Yn-2. Rows include plots like 地番 G-4 and their respective coordinates.

Table with columns: 地番, Xn, Yn, Yn-1, Xn-1, Xn-2, Yn-2. Rows include plots like 地番 G-5 and their respective coordinates.

X=64.450

X=64.400

Table with columns: 地番, Xn, Yn, Yn-1, Xn-1, Xn-2, Yn-2. Rows include plots like 地番 G-6 and their respective coordinates.

Table with columns: 地番, Xn, Yn, Yn-1, Xn-1, Xn-2, Yn-2. Rows include plots like 地番 G-7 and their respective coordinates.

Y=29.900

Y=29.950

Y=29.950

Table with columns: 地番, Xn, Yn, Yn-1, Xn-1, Xn-2, Yn-2. Rows include plots like 地番 G-8 and their respective coordinates.

Table with columns: 地番, Xn, Yn, Yn-1, Xn-1, Xn-2, Yn-2. Rows include plots like 地番 G-9 and their respective coordinates.

Table with columns: 地番, Xn, Yn, Yn-1, Xn-1, Xn-2, Yn-2. Rows include plots like 地番 G-10 and their respective coordinates.

Table with columns: 地番, Xn, Yn, Yn-1, Xn-1, Xn-2, Yn-2. Rows include plots like 地番 G-11 and their respective coordinates.

Table with columns: 地番, Xn, Yn, Yn-1, Xn-1, Xn-2, Yn-2. Rows include plots like 地番 G-12 and their respective coordinates.

Table with columns: 地番, Xn, Yn, Yn-1, Xn-1, Xn-2, Yn-2. Rows include plots like 地番 G-13 and their respective coordinates.

Table with columns: 地番, Xn, Yn, Yn-1, Xn-1, Xn-2, Yn-2. Rows include plots like 地番 G-14 and their respective coordinates.

Y=29.900

Y=29.900

Table with columns: 地番, Xn, Yn, Yn-1, Xn-1, Xn-2, Yn-2. Rows include plots like 地番 G-15 and their respective coordinates.

Table with columns: 地番, Xn, Yn, Yn-1, Xn-1, Xn-2, Yn-2. Rows include plots like 地番 G-16 and their respective coordinates.

Table with columns: 地番, Xn, Yn, Yn-1, Xn-1, Xn-2, Yn-2. Rows include plots like 地番 G-17 and their respective coordinates.

Table with columns: 地番, Xn, Yn, Yn-1, Xn-1, Xn-2, Yn-2. Rows include plots like 地番 G-18 and their respective coordinates.

Table with columns: 地番, Xn, Yn, Yn-1, Xn-1, Xn-2, Yn-2. Rows include plots like 地番 G-19 and their respective coordinates.

Table with columns: 地番, Xn, Yn, Yn-1, Xn-1, Xn-2, Yn-2. Rows include plots like 地番 G-20 and their respective coordinates.

Table with columns: 地番, Xn, Yn, Yn-1, Xn-1, Xn-2, Yn-2. Rows include plots like 地番 G-21 and their respective coordinates.

Table with columns: 地番, Xn, Yn, Yn-1, Xn-1, Xn-2, Yn-2. Rows include plots like 地番 G-22 and their respective coordinates.

Table with columns: 地番, Xn, Yn, Yn-1, Xn-1, Xn-2, Yn-2. Rows include plots like 地番 G-23 and their respective coordinates.

Table with columns: 地番, Xn, Yn, Yn-1, Xn-1, Xn-2, Yn-2. Rows include plots like 地番 G-24 and their respective coordinates.

Table with columns: 地番, Xn, Yn, Yn-1, Xn-1, Xn-2, Yn-2. Rows include plots like 地番 G-25 and their respective coordinates.

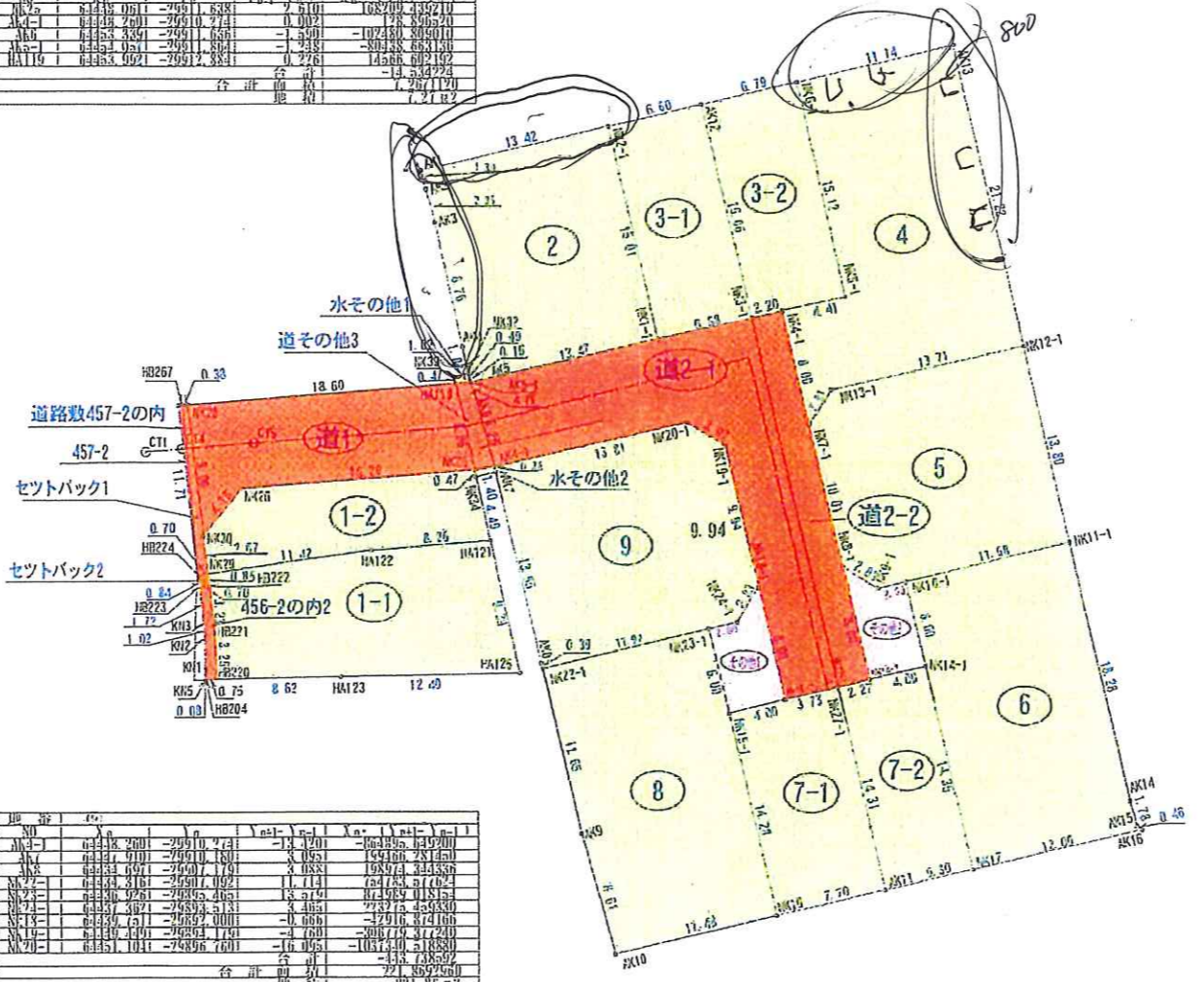

求積図

S=1:250 (A1)
S=1:500 (A3)

X=64.500

X=64.450

X=64.400

Table with columns: 地番, Xn, Yn, Yn-1, Xn-1, Xn-2, Yn-2. Rows include plots like 地番 G-1 and their respective coordinates.

Table with columns: 地番, Xn, Yn, Yn-1, Xn-1, Xn-2, Yn-2. Rows include plots like 地番 G-2 and their respective coordinates.

Table with columns: 地番, Xn, Yn, Yn-1, Xn-1, Xn-2, Yn-2. Rows include plots like 地番 G-3 and their respective coordinates.

Table with columns: 地番, Xn, Yn, Yn-1, Xn-1, Xn-2, Yn-2. Rows include plots like 地番 G-4 and their respective coordinates.

Table with columns: 地番, Xn, Yn, Yn-1, Xn-1, Xn-2, Yn-2. Rows include plots like 地番 G-5 and their respective coordinates.

Table with columns: 地番, Xn, Yn, Yn-1, Xn-1, Xn-2, Yn-2. Rows include plots like 地番 G-6 and their respective coordinates.

Table with columns: 地番, Xn, Yn, Yn-1, Xn-1, Xn-2, Yn-2. Rows include plots like 地番 G-7 and their respective coordinates.

Table with columns: 区画番号, 面積, 備考. Lists plot numbers and areas, such as 1-2 (95.55 m²), 1-1 (170.74 m²), etc.

開闢面積 2493.57 m²

Y=29.950

Y=-30,000

Y=-29,950

Y=-29,900

Y=-29,850

X=64,500

X=64,500

上水管施設計画図 下水管施設計画図



S=1:250 (A1)
S=1:500 (A3)

座標リスト

点名	X座標	Y座標	標高
Z-1	64442.984	-29931.589	
Z-2	64554.325	-29944.741	10.00
T1	64447.794	-29910.624	
T2	64414.839	-29889.211	9.75

凡例



流水方向	←
開発区域	——
境界	---

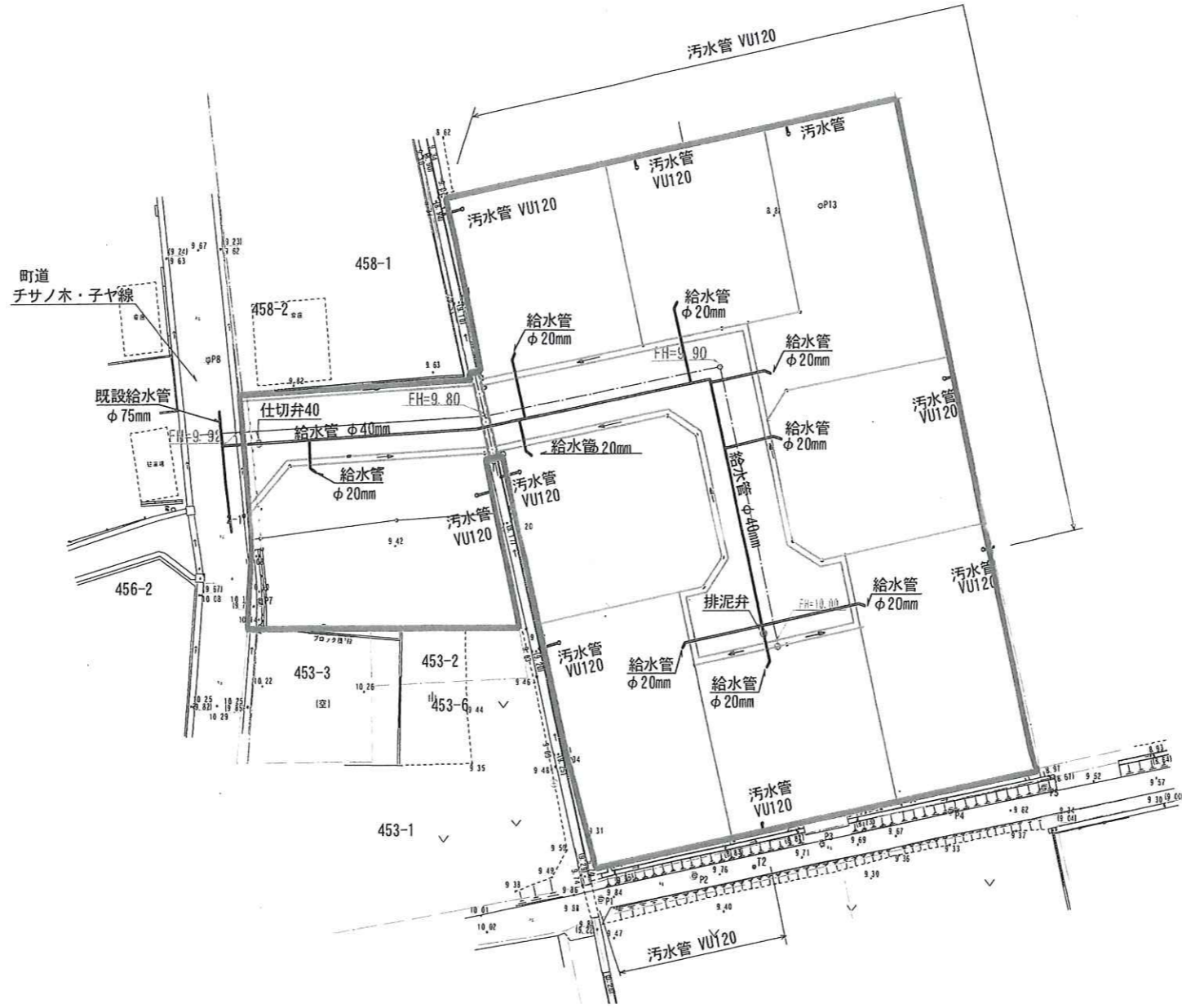

X=64,450

X=64,450

X=64,400

X=64,400

Y=-29,950

Y=-29,900

Y=-29,850

所在地	嘉穂郡桂川町大字土居410番外3筆	作成者	田川郡川崎町大字川崎960 南中村測量設計事務所 測量士 中村己年人	縮尺	S=1:250 (A1) S=1:500 (A3)	給水管施設計画図 汚水管施設計画図
				作成年月日	令和5年6月6日	

排水計画図



S=1:250 (A1)
S=1:500 (A3)

座標リスト

点名	X座標	Y座標	標高
Z-1	64442.984	-29931.589	
Z-2	64554.325	-29944.741	10.00
T1	64447.794	-29910.624	
T2	64414.839	-29889.211	9.75

凡例



水路	
流水方向	
開発区域	
境界	

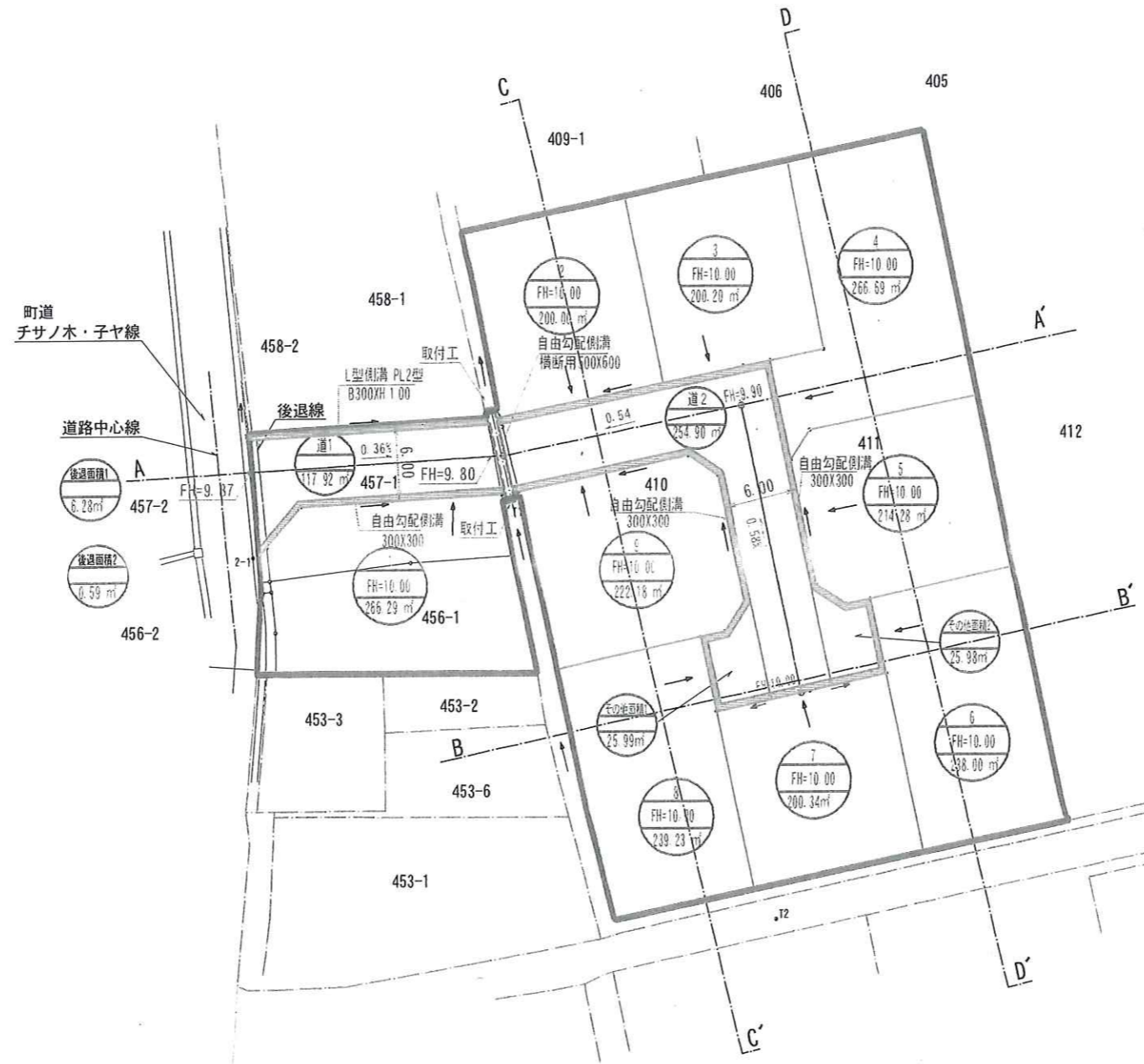

Y=30.000
X=64.500
Y=29.950
Y=29.900
Y=29.850
X=64.450
X=64.400
Y=29.950
Y=29.900
Y=29.850

所在地	作成者	縮尺	S=1:250 (A1) S=1:500 (A3)	排水計画図
	田川郡川崎町大字川崎960 御中村測量設計事務所 測量士 中村己年人	作成年月日	令和5年6月6日	

Y=30.000

Y=29.950

Y=29.900

Y=29.850

X=64.500

X=64.500

造成計画平面図



S=1:250 (A1)
S=1:500 (A3)

拡大図

S=1:100

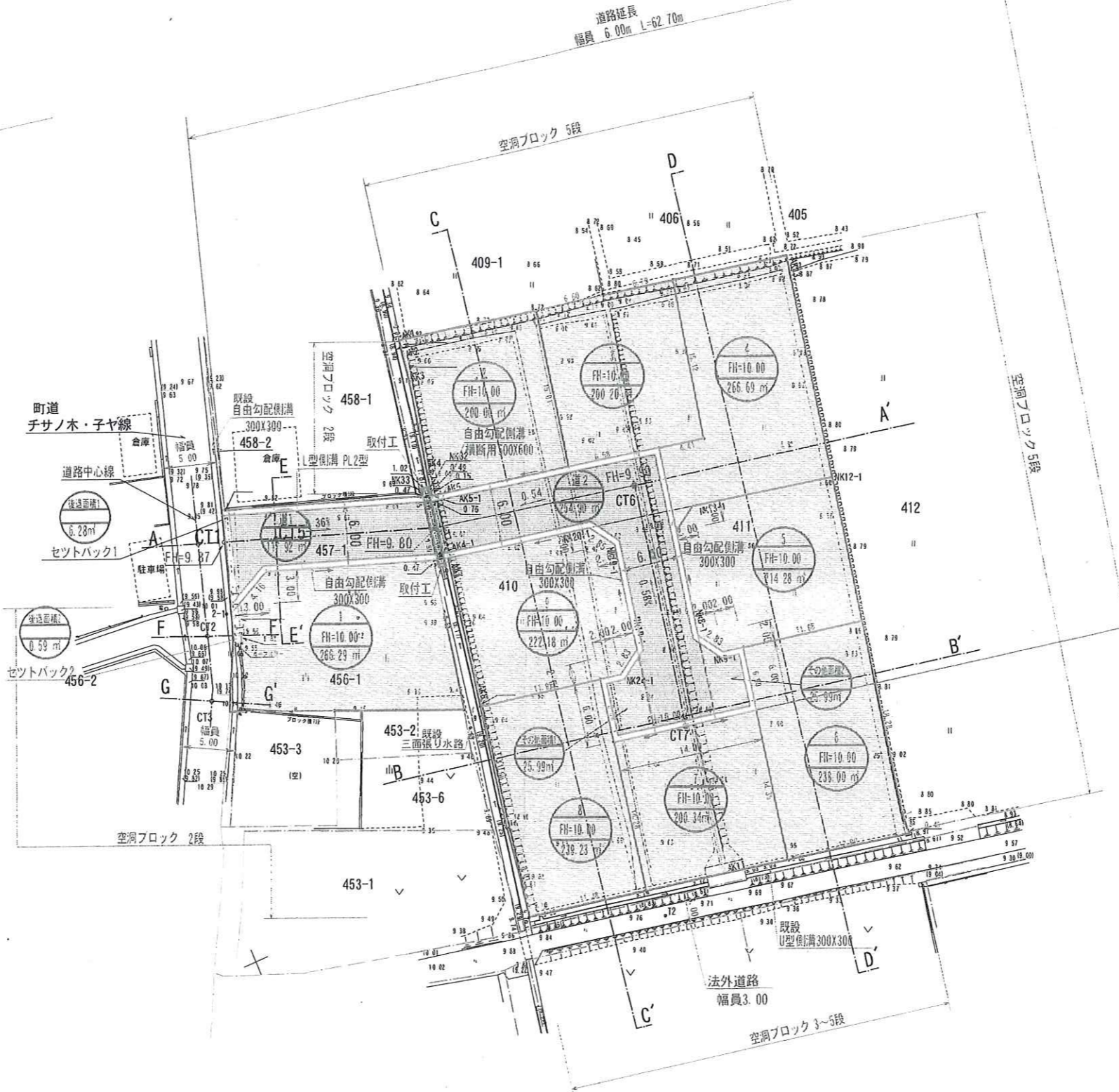
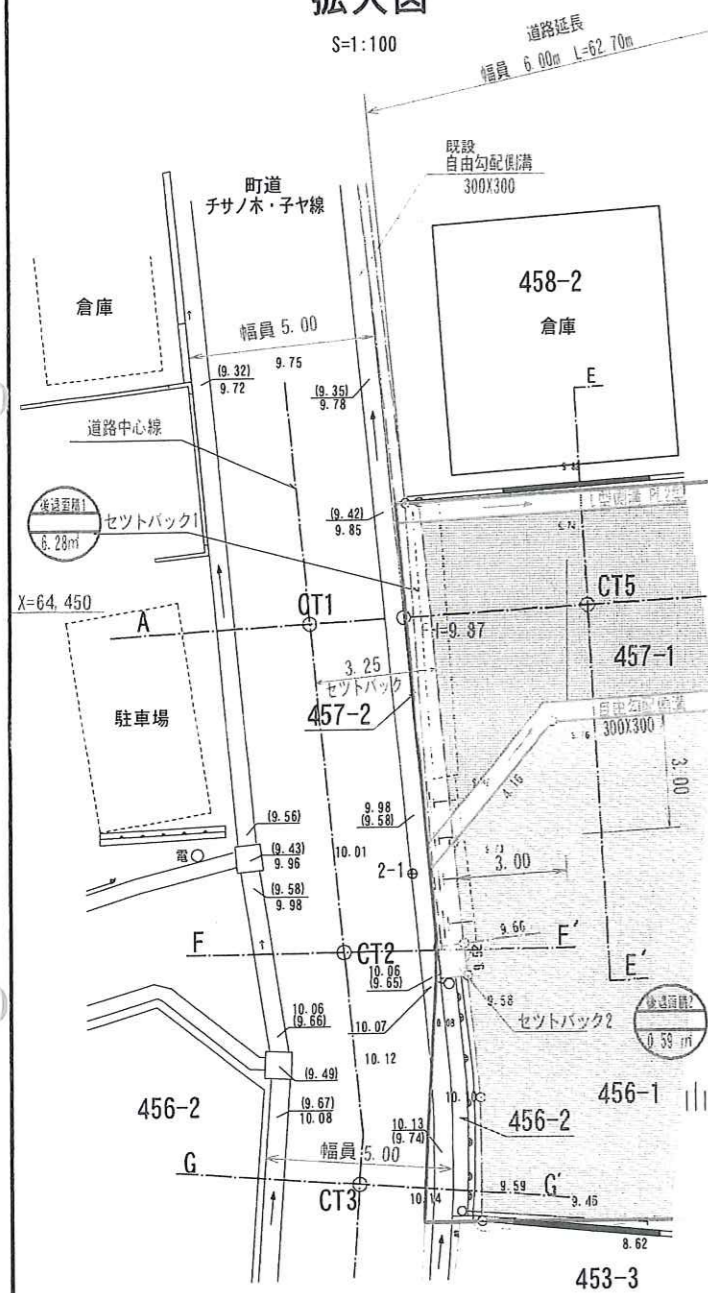

座標リスト

点名	X座標	Y座標	標高
2-1	64442.984	-29931.589	
2-2	64554.325	-29944.741	10.00
T1	64447.794	-29910.624	
T2	64414.839	-29889.211	9.75

凡例



道路	
宅地	
水路	
流水方向	
開発区域	
境界	
セットバック	
その他	

開発面積
2497.54 m²

X=64.400

Y=29.950

Y=29.900

Y=29.850

X=64.400

所在地	嘉穂郡桂川町大字土居410番外3筆	作成者	田川郡川崎町大字川崎960 楠中村測量設計事務所 測量士 中村巳年人	縮尺	S=1:250 (A1) S=1:500 (A3)	造成計画平面図
作成年月日	令和5年6月6日					

自由勾配側溝300X300
S=1/20

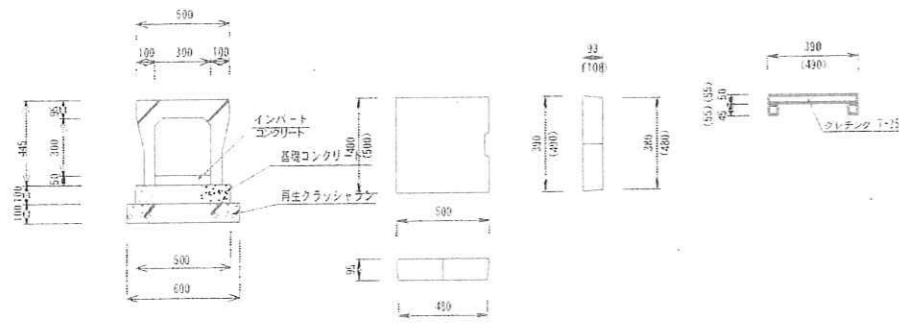

自由勾配側溝蓋
S=1/20

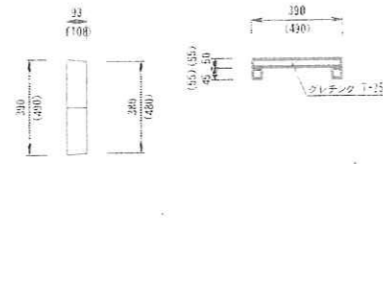

数量表

10M当り

種別	H	H1	H2	基礎部分の長さ	基礎型枠	基礎コンクリート	縦	横	グレーチング	インポートコンクリート
300X300	0.445	0.395	0.05	6.00	2.00	0.50	10.00	8.00	1.00	0.15

空洞ブロック積

(2段積) S=1/20

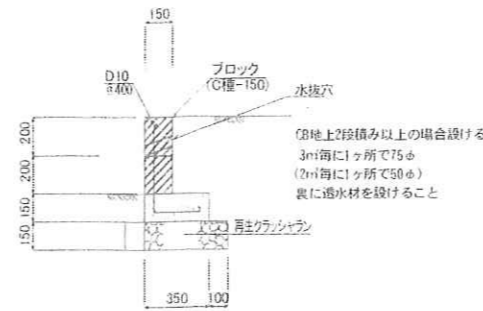

※注 高さ H≦1mかつCB5段積以下
ブロック 〇種-150
鉄筋 9φ以上 壁頂、基礎には横筋、隅角部には縦筋
鉄筋末端は、かぎ状に折り曲げてかぎかけ定着
ブロック縦目地 鉄筋を入れた空洞部にはコンクリート充てん

空洞ブロック積

(3~5段積) S=1/20

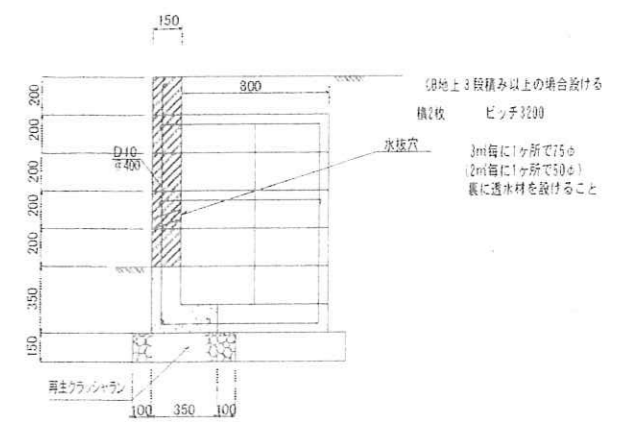

空洞ブロック積 正面図

S=1/20

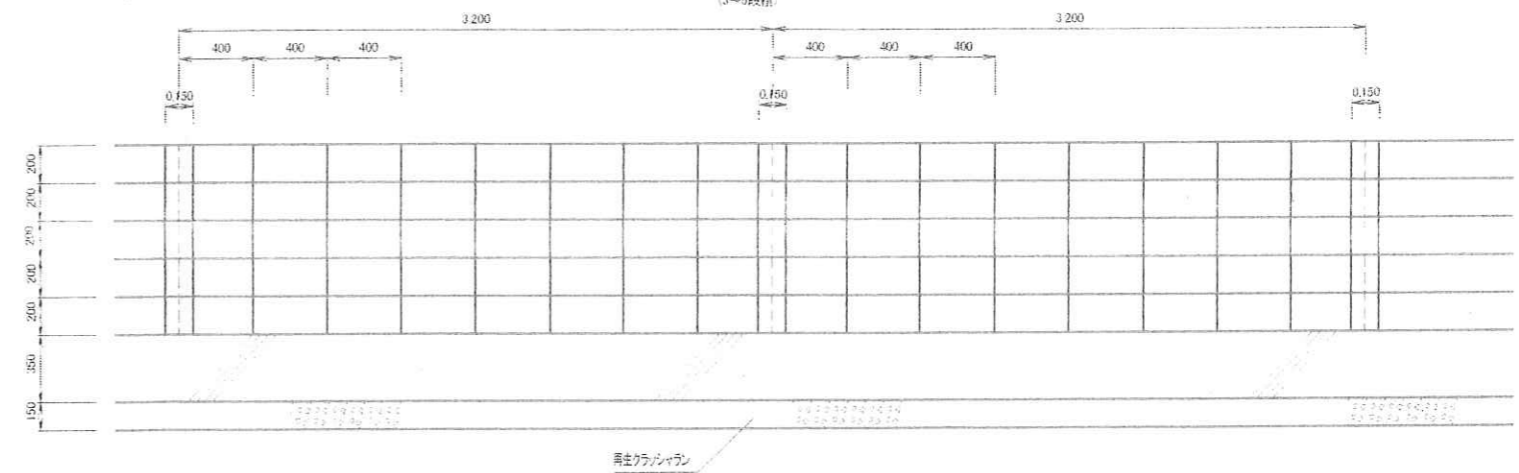

L型側溝 S=1/20

舗装工

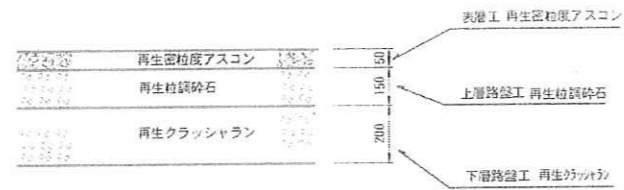
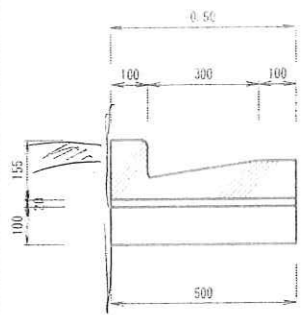

舗装工面積

S=1/250

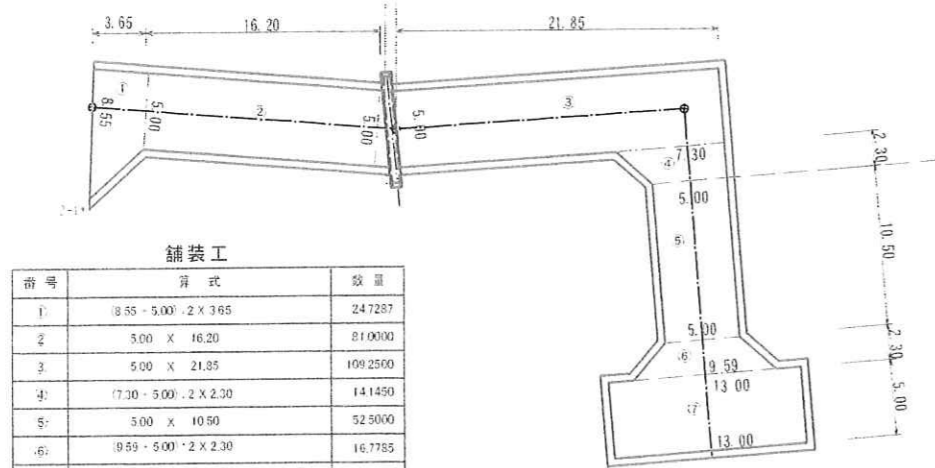

舗装工

番号	算式	数量
1	(8.55 - 5.00) × 2 × 3.65	24.7287
2	5.00 × 16.20	81.0000
3	5.00 × 21.85	109.2500
4	(7.30 - 5.00) × 2 × 2.30	14.1400
5	5.00 × 10.50	52.5000
6	(8.55 - 5.00) × 2 × 2.30	16.7755
7	5.00 × 13.00	65.0000
計		358.9022

舗装面積 358.90㎡

舗装構成

S=1/50

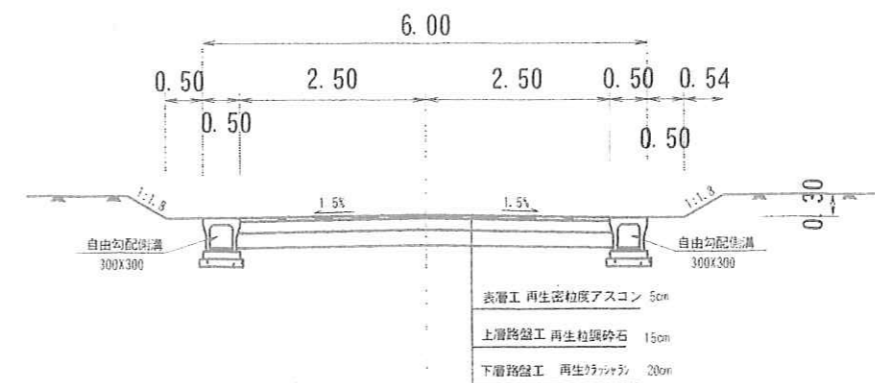

平面図

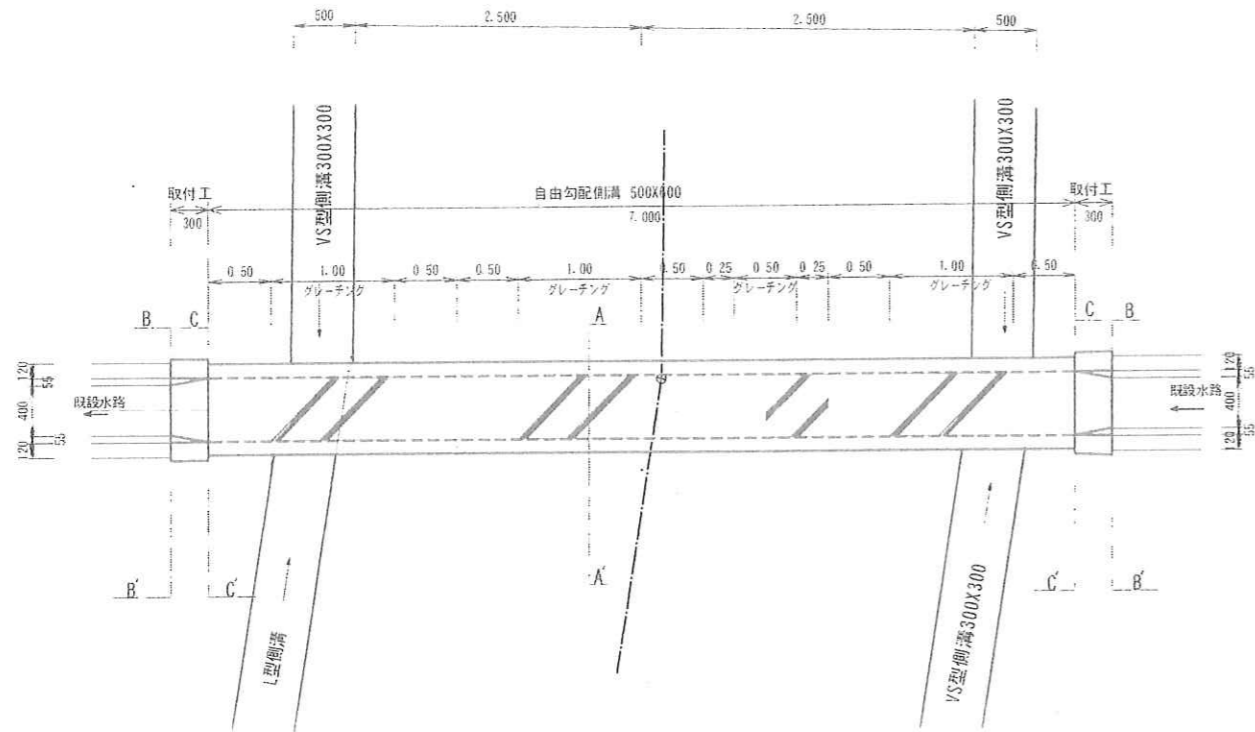

側面図

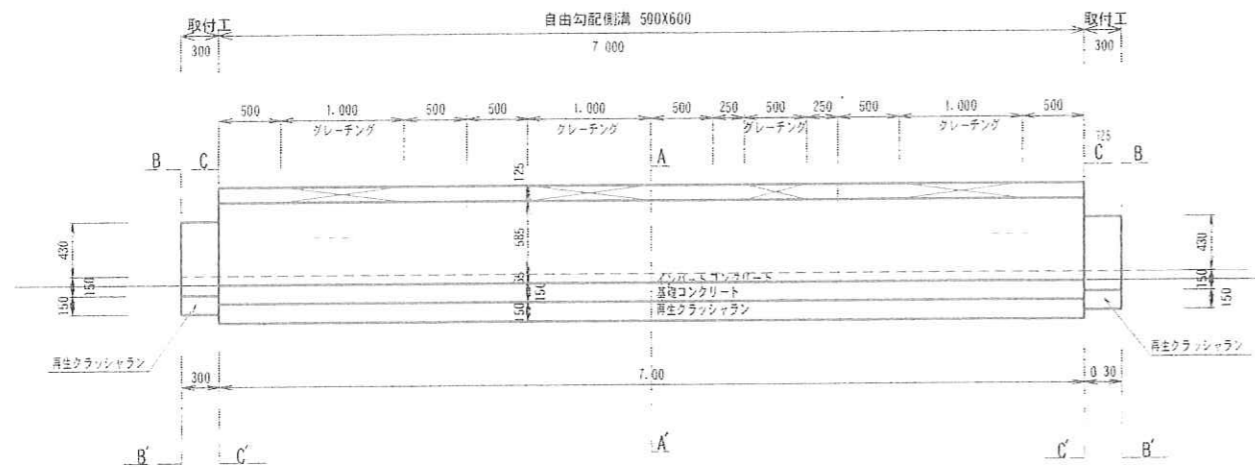

計画平面図
S=1:50

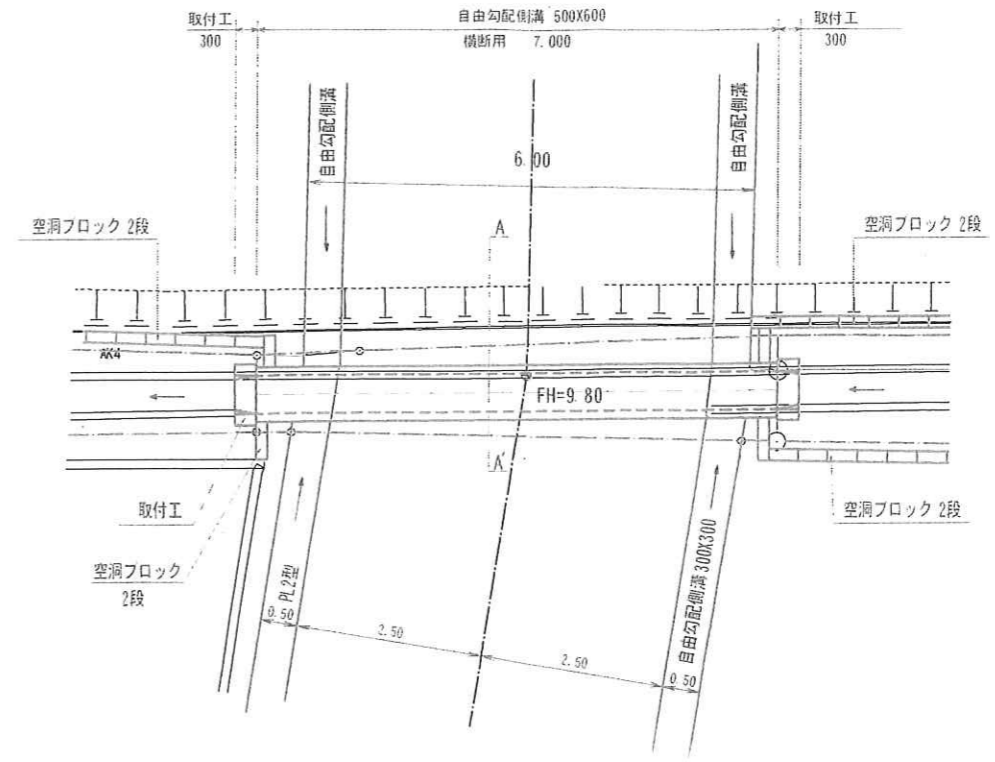

断面図

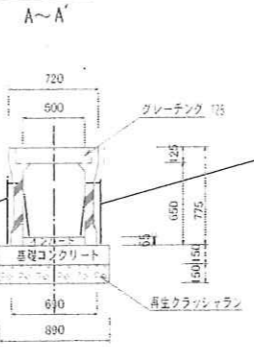

基礎耐圧 4 t/m²

断面図

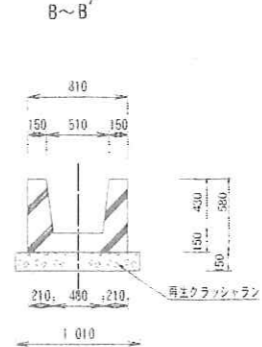

断面図

